

॥ श्री ॥



STEP INTO THE WORLD OF
YOUR DREAMS





A grand lifestyle, A symbol of grandeur and unparalleled comfort offering a unique taste of luxury living with a modern contemporary design, and a complete new concept that redefines intelligent urban planning.

Welcome To Shree Govind Bhuvan, Homes That Ensures Top Notch

STANDARD OF LIVING

20 YEARS OF EXCELLENCE IN CONSTRUCTION INDUSTRY

We at Vikas Developers have great pride in expressing that we have always believed in building Best Quality Homes for our demanding customers.

We have always ensured use of Quality Materials and Best Technical standards to build The Dream Homes. In last 20 years we have delivered stand alone apartments in heart of the city, Group Housing Projects consisting 200 + tenements, Commercial & High Rise building in & around the Aurangabad City. We are totally focused on Quality Standards and most importantly, timely possession to our satisfied customers. For our commitments towards our work, we have been awarded with the most Prestigious Award : "Developer of the City".

In our project "Shree Govind Bhuvan" we have tried to give best of living spaces with Quality Specifications & Standards. Since We Know "VALUE FOR MONEY" & for which our group is known as - "Symbol of quality & trust".





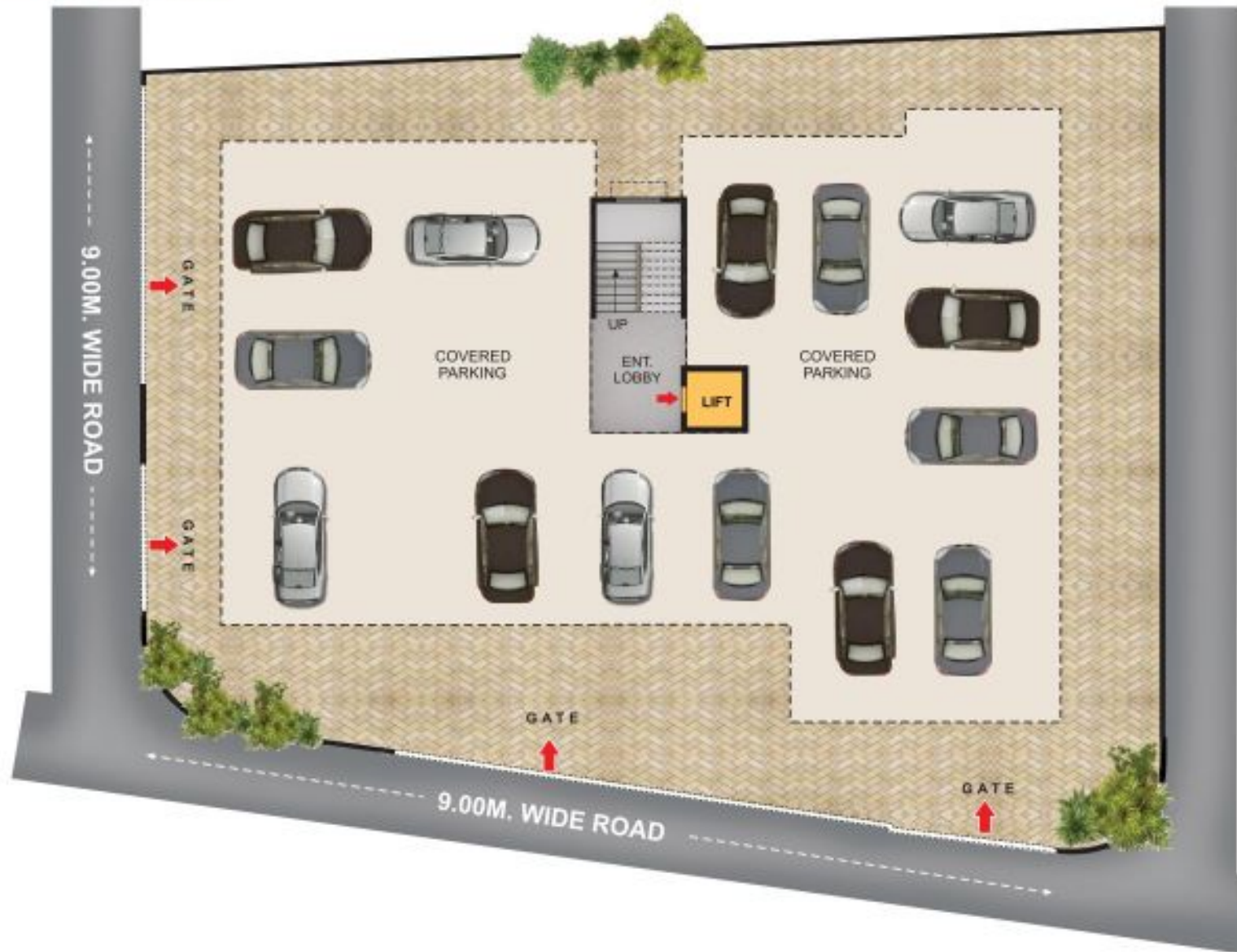

GROUND (PARKING) FLOOR PLAN



	Terrace
4 th Floor	401, 402, 403
3 rd Floor	301, 302, 303
2 nd Floor	201, 202, 203
1 st Floor	101, 102, 103
Parking	Ground Floor

FLOOR PLAN



TYPICAL FIRST, SECOND, THIRD & FOURTH FLOOR PLAN



Specifications

- **Structure** "RCC Framed Structure, External walls 6" & internal walls in 4" in brick masonry work.

- **Plaster**
 - Internal Gypsum Finish (POP)
 - External Double Coat sand faced plaster.

- **Flooring**
 - Hall, Dining, Kitchen, Bed Room & Passage 800 X 800 Kajaria vitrified tiles or equivalent.
 - Toilet Dado – 300 X 600 Kajaria wall tiles or equivalent.
 - Staircase Steps & Passages Natural Stone / Vitrified tiles.

- **Doors**
 - Decorative Main door with both side laminations with Godrej /Europa or Equivalent Latch.
 - Toilet doors are of granite frame with FRP coated doors.
 - Rest of the doors are flush door with both side lamination.

- **Windows** Powder Coated aluminum sliding windows with mosquito net with safety grills & granite window sill on all 4 sides of windows.

- **Kitchen** Granite platform (10 Ft. length) in black granite with S.S. Sink with wall tiles up to ceiling level.

- **Toilet**
 - Sanitary Fixtures – Standard.
 - Plumbing Fixtures – Jaquar (ESSCO – Builders Range).

- **Electrical**
 - Concealed wiring with modular switches (Anchor or equivalent).
 - A.C. point in Master bedroom & Inverter point in each room.

- **Paints**
 - Internal - Plastic emulsion paint of standard make.
 - External - Premium quality acrylic paint.

- **Parking** Ample parking space covered with paving blocks / parking tiles / tremix.

- **Lift** Kone / Otis or Equivalent.

- **Terrace** Brick bat coba water proofing at terrace.

- **Water Tank** One over head water tank & one underground water tank with separate partition for domestic use & drinking use water.

Extra Amenities



CCTV - Security For Common Area



POP Running For Internal Walls



Executive Entrance Lobby



Safety Door For Main Door



Granite Window Sill For All Four Sides Of Window



Inverter For Every Flat



UPS Backup For Lift



Ample Car Parking





Unwind yourself to an experience so breath taking...
it is sure to make you fall in love with the home you stay in where...

LIFE IS MEANT TO BE BEAUTIFUL.

A project at par with high- class standards and cutting-edge infrastructure
and a standard of living that aspires the best for its residents.



THE PLACE WHERE LIFE IS ENJOYMENT & BLESSING...



Shree Govind Bhuvan enjoys a prime location and is strategically located around the best fitness clubs, schools, hospitals, shopping centers and all the major city attraction. A grand lifestyle awaits you here providing a unique blend of luxury & harmonious living.



Project By :



vikas developers
Symbol of quality & trust

Office : 'Shree Dnyanesh Arcade', Opp. Sai Hospital, Samarth Nagar, Aurangabad.

Credits

Architects
**Manish Kale &
Associates**

Structural Consultant
**Vikas L. Chaudhary &
Associates**

Legal Advisor
Adv. Subhash Malani

Brand Promotion
Ashok Deshpande
Wings Creative



MAHARERA : P51500020454

Cell : 7767800191, 9764466527, 9822034291, 7767800192

Disclaimer: This brochure is purely conceptual & not a legal offering. The plans, specifications, images & other details herein are indicative. Furniture & accessories will not be provided by the developer & the developer / owner reserves all the rights to change. All dimensions mentioned in the drawings may vary / differ due to construction contingencies & site conditions. All dimensions are shown from unfinished surfaces. The printed material does not constitute a offer of any type between the developer / owner & the recipient. Any purchase / lease of this development shall be governed by terms & conditions of agreement for sale / lease entered into between parties & no details mentioned in this printed material shall in any way govern such transaction.